

GENERAL NOTES

- THESE PLANS ARE BASED ON A TOPOGRAPHIC SURVEY CONDUCTED WITH A FOUR SECOND TOTAL STATION ON 9/20/06 AND A THREE SECOND TOTAL STATION ON 6/13/2019 BY OTTER CREEK ENGINEERING, INC.
- IN THE PREPARATION OF THESE PLANS, DATA FROM THE FOLLOWING SOURCES WAS INCORPORATED:
 - A PLAN PREPARED BY OTTER CREEK ENGINEERING, ENTITLED: "RUTLAND COUNTY SOLID WASTE DISTRICT - GLEASON ROAD FACILITY IMPROVEMENTS - RUTLAND VERMONT" - DATED: 7/25/17, WITH REVISION 1 DATED 8/14/17.
- ELEVATION IS BASED ON NAVD88. BENCHMARK IS LOCATED APPROXIMATELY 560' WESTERLY DOWN GLEASON ROAD, TO THE GRAVEL PARKING AREA FOR THE STAFFORD TECHNICAL CENTER, JUST EAST OF THE INTERSECTION WITH US ROUTE 4. THE NGS DATA POINT IS LOCATED IN A ROCK OUTCROP, FLUSH WITH THE PARKING LOT SURFACE.
- COORDINATE SYSTEM IS BASED ON AN ASSUMED 5000N,5000E BASE POINT AND MAGNETIC NORTH AT TIME OF SURVEY.
- FOR CLARITY, TEXT DENOTING EXISTING ITEMS IS SHOWN IN LOWER CASE, AND TEXT DENOTING PROPOSED ITEMS IS UPPERCASE AND BOLD.
- REFER TO LEGEND LOCATED ON THIS SHEET FOR SYMBOL DESIGNATIONS.
- ALL UNDERGROUND UTILITIES ARE SHOWN AS APPROXIMATE LOCATIONS.
- THIS IS NOT A BOUNDARY SURVEY.
- TECHNICAL SPECIFICATIONS ACCOMPANY THESE PLANS AND ARE ESSENTIAL FOR CONSTRUCTION OF THIS PROJECT.

LEGEND

	boundary line/r.o.w.
	road/parking (w/ surface label)
	drive (w/ surface label)
	tree line/hedge row
	1 foot contour
	5 foot contour
	stone wall
	wetlands
	underground electric
	overhead utility
	underground telephone
	ditch line/drainage
	storm drain
	water main
	sanitary sewer
	sewer force main
	liquid propane
	signs
	light pole
	utility pole
	guy
	gate valve
	curb stop
	hydrant
	iron pipe found
	catch basin
	sewer manhole
	deciduous tree
	coniferous tree
	shrub, bush
	stump
	monitoring well
	traverse station
	temporary bench mark
	SILT FENCE
	WETLAND AND BUFFER PLANTING AREA

SAFETY NOTES

- CONTRACTOR SHALL BE RESPONSIBLE FOR INITIATING, MAINTAINING AND SUPERVISING ALL WORK SAFETY PRECAUTIONS AND PROGRAMS IN CONNECTION WITH THE WORK. CONTRACTOR SHALL TAKE ALL NECESSARY PRECAUTIONS TO PREVENT DAMAGE, INJURY OR LOSS TO:
 - ALL EMPLOYEES ON THE WORK SITE AND OTHER PERSONS WHO MAY BE AFFECTED.
 - THE WORK SITE AND ALL THE MATERIALS AND EQUIPMENT TO BE INCORPORATED WHETHER IN STORAGE ON OR OFF THE SITE.
 - OTHER PROPERTY AT THE SITE OR ADJACENT, INCLUDING BUT NOT LIMITED TO TREES, SHRUBS, LAWNS, WALKS, PAVEMENTS, ROADWAYS, STRUCTURES AND UTILITIES NOT DESIGNATED FOR REMOVAL, RELOCATION, OR REPLACEMENT IN THE COURSE OF CONSTRUCTION.
- CONTRACTOR SHALL COMPLY WITH ALL APPLICABLE LAWS, ORDINANCES, RULES, REGULATIONS AND ORDERS (INCLUDING O.S.H.A. REGULATIONS) OF ANY PUBLIC BODY HAVING JURISDICTION OVER THE SAFETY OF PERSONS OR PROPERTY.
- THE CONTRACTOR SHALL NOTIFY OWNERS OF ADJACENT PROPERTY AND UTILITIES WHEN EXECUTION OF THE WORK WILL AFFECT THEM.
- THE CONTRACTOR'S DUTIES AND RESPONSIBILITIES FOR THE SAFETY AND PROTECTION OF THE WORK SHALL CONTINUE UNTIL SUCH TIME AS ALL THE WORK IS COMPLETED.
- THE LOCATION OF EXISTING UNDERGROUND UTILITIES ARE SHOWN IN AN APPROXIMATE WAY ONLY AND HAVE NOT BEEN INDEPENDENTLY VERIFIED BY THE OWNER OR ITS REPRESENTATIVE. THE CONTRACTOR SHALL DETERMINE THE EXACT LOCATION OF ALL EXISTING UTILITIES BEFORE COMMENCING WORK, AND AGREES TO BE FULLY RESPONSIBLE FOR ANY AND ALL DAMAGES WHICH OCCUR BY THE CONTRACTOR'S FAILURE TO EXACTLY LOCATE AND PRESERVE ANY AND ALL UNDERGROUND UTILITIES.
- CONTRACTOR SHALL COORDINATE WITH DIG-SAFE (888)-344-7233 OR WWW.DIGSAFE.COM A MINIMUM OF 48 HOURS PRIOR TO PERFORMING ANY EXCAVATION.
- AT THE CLOSE OF EACH WORK DAY, THE CONTRACTOR SHALL BACKFILL OR ADEQUATELY BARRICADE ALL OPEN TRENCHES.

MAINTENANCE NOTE

- THE GATE HAS A 4 FT. WIDE MAINTENANCE AREA, CENTERED ON THE GATE TO ALLOW VEGETATION TO BE MANAGED TO ALLOW THE GATE TO REMAIN OPERATIONAL.

ABBREVIATIONS

BD	- BELOW DECK	MH	- MANHOLE
CI	- CAST IRON	MJ	- MECHANICAL JOINT
CB	- CATCH BASIN	NFL	- NOT FIELD LOCATED
CL	- CLASS	NFLTD	- NO LEDGE TO DEPTH
CMP	- CORRUGATED METAL PIPE	NTS	- NOT TO SCALE
CS	- CURB STOP	PVC	- POLYVINYL CHLORIDE
DI	- DUCTILE IRON	ROW	- RIGHT OF WAY
DMH	- DRAIN MANHOLE	SCH	- SCHEDULE
FL	- FLANGE	SD	- STORM DRAIN
FM	- FORCE MAIN	SMH	- SEWER MANHOLE
FRP	- FIBERGLASS REINFORCED PLASTIC	TBM	- TEMPORARY BENCH MARK
GPM	- GALLONS PER MINUTE	TBA	- TO BE ABANDONED
GSP	- GALVANIZED SERVICE PIPE	TBR	- TO BE REMOVED
GV	- GATE VALVE	TMH	- TELEPHONE MANHOLE
HDPE	- HIGH DENSITY POLYETHYLENE	WMH	- WATER MANHOLE
INV	- INVERT	UE	- UNDERGROUND ELECTRIC
IP	- IRON PIPE/PIN	U.N.O.	- UNLESS NOTED OTHERWISE
IPF	- IRON PIPE/PIN FOUND		

EROSION CONTROL NOTES

- THE PROJECT IS NOT REQUIRED TO OBTAIN COVERAGE UNDER THE STATE OF VERMONT'S CONSTRUCTION GENERAL PERMIT (3-9020).
- THE CONTRACTOR IS RESPONSIBLE FOR COMPLIANCE WITH THE STATE OF VERMONT WATER QUALITY STANDARDS. ANY FINES ASSESSED BY REGULATORY AGENCIES FOR THE NONCOMPLIANCE WITH STATE WATER QUALITY STANDARDS SHALL BE THE RESPONSIBILITY OF THE CONTRACTOR. THE CONTRACTOR IS RESPONSIBLE FOR PROVIDING THE PERSONNEL REQUIRED TO INSPECT AND MAINTAIN EROSION PREVENTION AND SEDIMENT CONTROL BEST MANAGEMENT PRACTICES (BMPs) FOR THIS PROJECT.
- THE EROSION PREVENTION AND SEDIMENT CONTROL MEASURES SHOWN ON THE PLANS DO NOT RELIEVE THE CONTRACTOR'S RESPONSIBILITY TO OBSERVE, EVALUATE AND CONSIDER ALTERNATIVES AND TO PROPOSE APPROPRIATE RECOMMENDATIONS IN ORDER TO LIMIT POTENTIAL WATER QUALITY IMPACTS.
- EROSION CONTROL MEASURES SHALL BE MONITORED AND MAINTAINED THROUGHOUT CONSTRUCTION AND REMOVED AFTER PROJECT AREA AND DRAINAGE COURSES ARE FULLY ESTABLISHED AND STABLE.
- ALL DISTURBED AREAS NOT UNDER ACTIVE CONSTRUCTION SHALL BE STABILIZED BY ROUGH GRADING TO MINIMIZE SLOPES AND MULCHED. FOLLOWING FINAL GRADING OF ANY PORTION OF THE SITE, CONTRACTOR SHALL LOAM, SEED AND MULCH WITHIN ONE WEEK.
- REFER TO CONTRACT SPECIFICATIONS AND DETAILS FOR ADDITIONAL INFORMATION.
- THE CONTRACTOR SHALL INSTALL INLET PROTECTION ON ALL CATCH BASINS WITHIN 100 FEET DOWN GRADIENT OF THE ACTIVELY WORKED CONSTRUCTION AREA. INLET PROTECTION BEST MANAGEMENT PRACTICES SHALL BE INSTALLED PRIOR TO THE START OF WORK AND IN ACCORDANCE WITH MANUFACTURER'S RECOMMENDATIONS.

CONSTRUCTION NOTES

- CONTRACTOR SHALL REMOVE AND DISPOSE OF ALL FILL MATERIAL IN THE AREA INDICATED.
- ALL BARE SLOPES SHALL BE SEEDED WITH CONSERVATION SEED MIX.

BUFFER PLANTING NOTES

- TREES MUST BE MINIMUM OF 6 FEET TALL AND SHRUBS MUST BE A MINIMUM OF 3 FEET TALL.
- TREE SPECIES MAY INCLUDE ACER RUBRUM (RED MAPLE), CARPINUS CAROLINIANA (AMERICAN HORNBEAM), ACER SACCHARINUM (SILVER MAPLE), OR BETULA NIGRA (RIVER BIRCH). SHRUB SPECIES MAY INCLUDE CORNUS AMOMUM (SILKY DOGWOOD), CORNUS SERICEA (RED-OSIER DOGWOOD), ILEX VERTICILLATA (WINTERBERRY HOLLY), VIBURNUM DENTATUM (ARROWWOOD), VIBURNUM LENTAGU (MANNYBERRY), VIBURNUM TRILOBUM (HIGH BUSH CRANBERRY), CORYLUS AMERICANA (AMERICAN HAZELNUT), OR SALIX SERICEA (SILKY WILLOW). ONLY NATIVE SPECIES MAY BE USED, AND SPECIES NOT LISTED HERE MUST BE APPROVED PRIOR TO PLANTING.
- THE BUFFER RESTORATION PLANTING PLAN HAS BEEN DEVELOPED UTILIZING THE FOLLOWING DOCUMENT: A: PLANTING GUIDANCE FOR THE REVEGETATION OF RIPARIAN AREAS IN VERMONT, BY RICH KERN, VERMONT FISH AND WILDLIFE DEPARTMENT, JANUARY 2016.

BUFFER PLANTING SCHEDULE

SYMBOL	QUANTITY	TYPE	NOTES
⊕	5	TREES	PLANT TREES UP TO 20 FEET APART (INCLUDING FROM EXISTING TREES)
•	43	SHRUBS	PLANT SHRUBS 3' TO 5' APART IN GROUPS

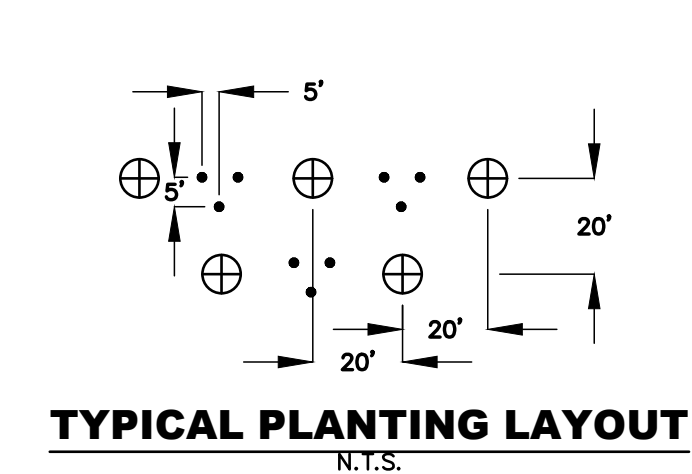

NOTE:

PLANTINGS SHALL BE MONITORED OVER A TWO YEAR PERIOD. ANY DEAD PLANTING DURING THAT PERIOD SHALL BE REPLACED.

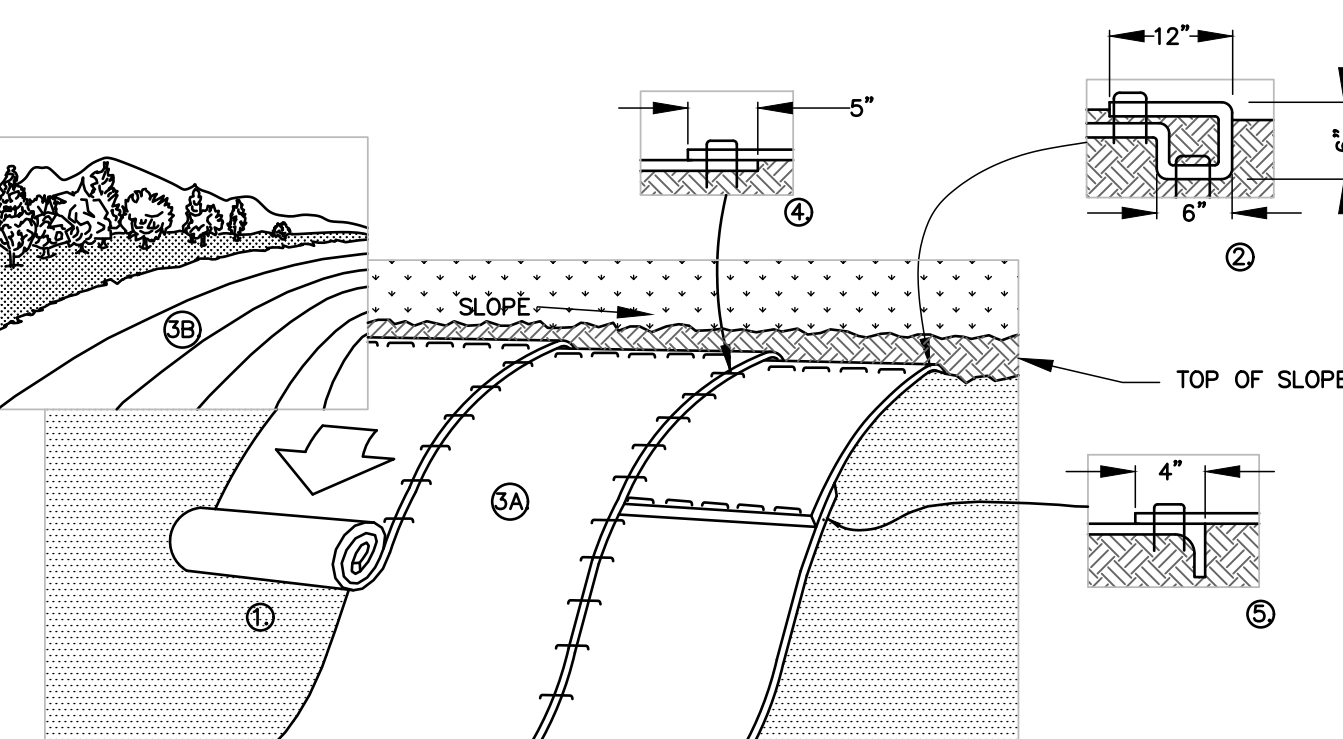
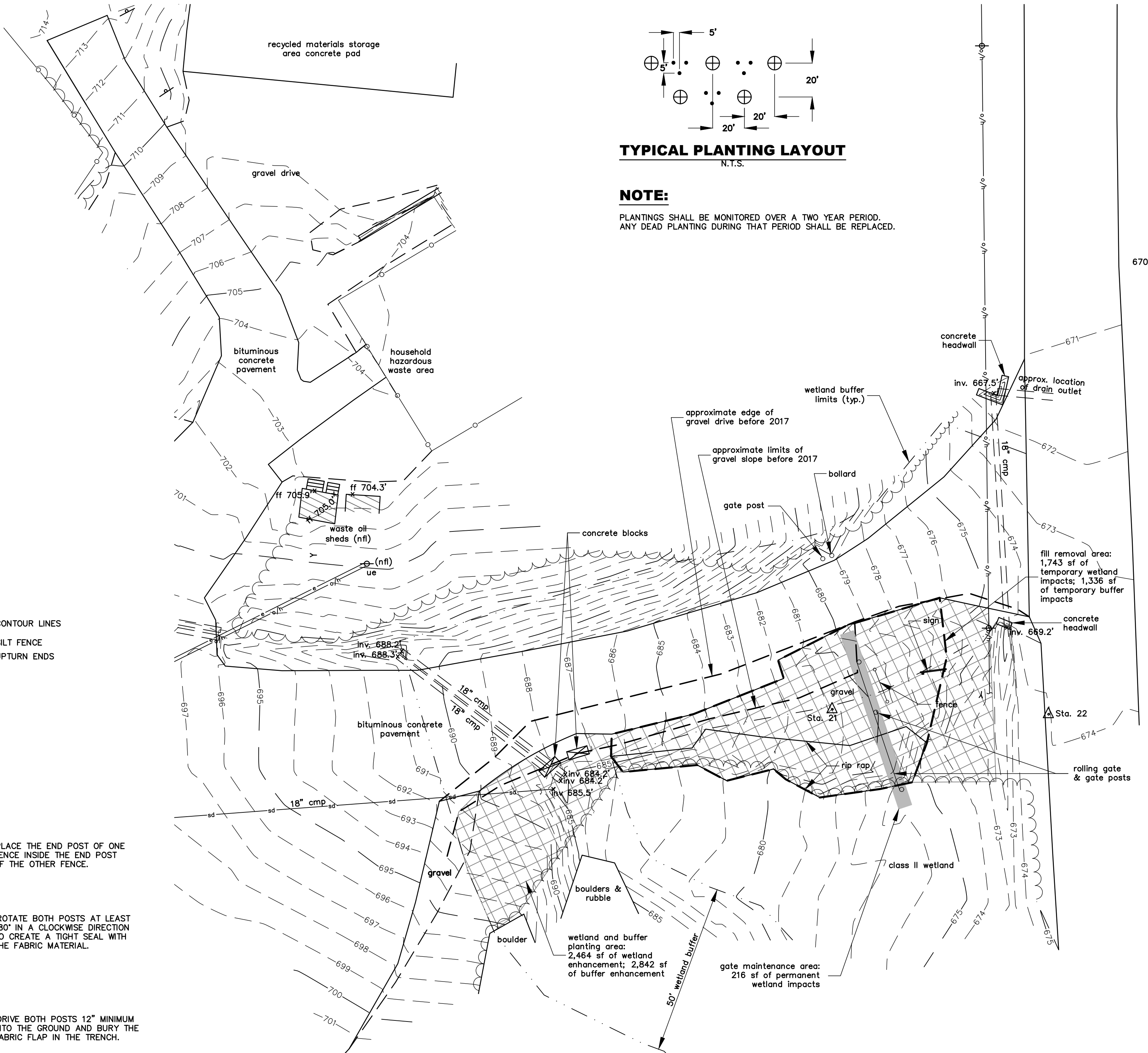

- NOTES:**
- SOIL SHALL BE PREPARED PRIOR TO INSTALLING BLANKETS, INCLUDING ANY NECESSARY APPLICATION OF LIME, FERTILIZER AND SEED.
 - BLANKET AT TOP OF THE SLOPE TO BE ANCHORED IN A 6" DEEP X 6" WIDE TRENCH WITH APPROXIMATELY 12" OF BLANKET EXTENDED BEYOND THE UP-SLOPE PORTION OF THE TRENCH. ANCHOR THE BLANKET WITH A ROW OF STAPLES/STAKES APPROXIMATELY 12" APART IN THE BOTTOM OF THE TRENCH. TRENCH SHALL BE BACKFILLED AND COMPACTED AFTER STAPLING. SECURE BLANKET OVER SOIL WITH ROW OF STAPLES/STAKES SPACED APPROXIMATELY 12" APART ACROSS THE WIDTH OF THE BLANKET.
 - ROLL THE BLANKETS (A) DOWN OR (B) HORIZONTALLY ACROSS THE SLOPE WITH APPROPRIATE SIDE AGAINST THE SOIL SURFACE. ALL BLANKETS MUST BE SECURELY FASTENED TO SOIL SURFACE BY PLACING STAPLES/STAKES.
 - THE EDGES OF PARALLEL BLANKETS MUST BE STAPLED WITH APPROXIMATELY 5" OVERLAP.
 - CONSECUTIVE BLANKETS SPICED DOWN THE SLOPE SHALL BE PLACED END OVER END (SHINGLE STYLE) WITH AN APPROXIMATE 4" OVERLAP. BURY END OF LOWER FABRIC 6" DEEP AND STAPLE THROUGH OVERLAPPED AREA, APPROXIMATELY 12" APART ACROSS ENTIRE BLANKET WIDTH.
 - ROLLED EROSION PRODUCT REQUIRED ON ALL SLOPES 3:1 (3' HORIZ. TO 1' VERT.) OR GREATER.
 - ROLLED EROSION CONTROL PRODUCT SHALL BE DRY AND DEGRADABLE PROCESSED NATURAL OR POLYMER FIBERS MECHANICALLY, STRUCTURALLY OR CHEMICALLY BOUND TOGETHER TO FORM A CONTINUOUS MATRIX, COMPLYING WITH SPECIFICATIONS.

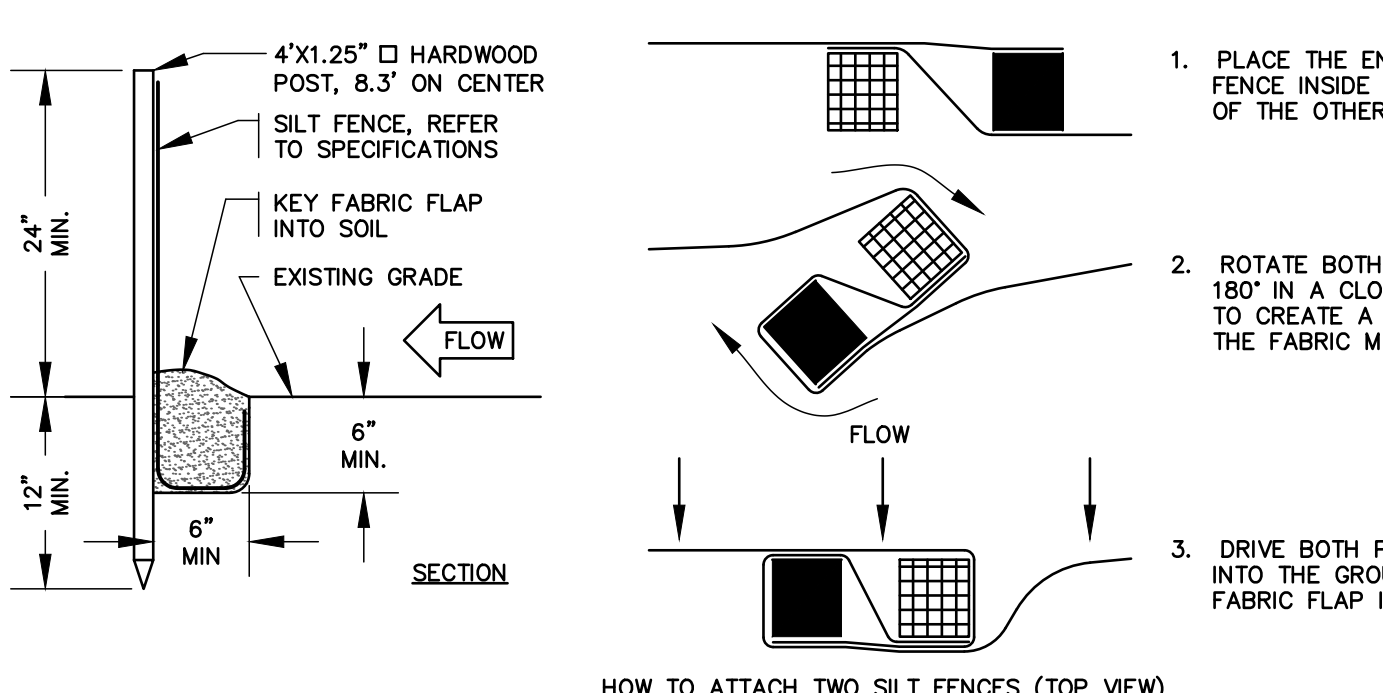
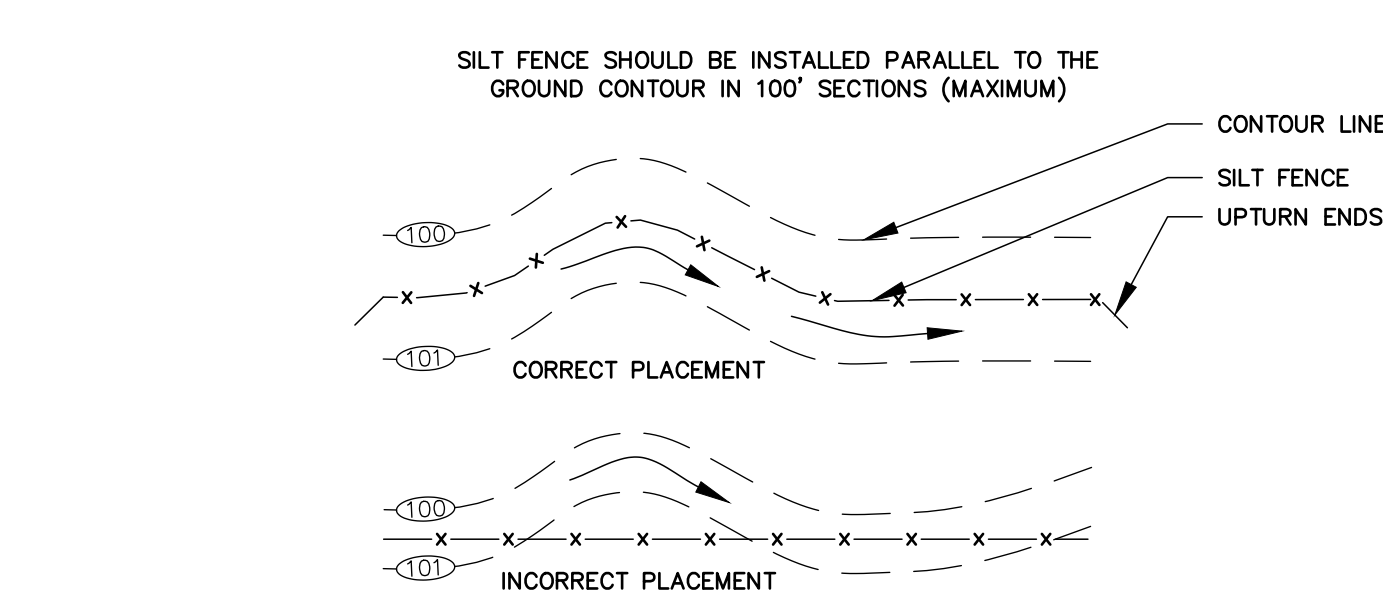

- NOTES:**
- SILT FENCE SHALL BE INSTALLED AT THE DOWNHILL SIDE OF CONSTRUCTION ACTIVITIES BEFORE UPSLOPE LAND DISTURBANCE BEGINS.
 - REFER TO TECHNICAL SPECIFICATIONS FOR ADDITIONAL INFORMATION.

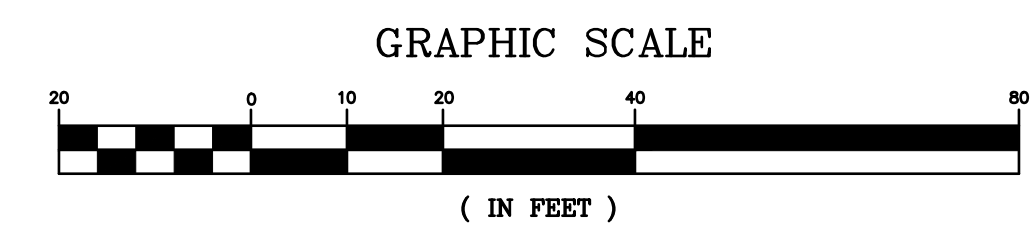

OTTER CREEK ENGINEERING

404 East Main Street
P.O. Box 712
East Middlebury, VT 05740
Telephone: 802.382.8522
Fax: 802.382.8640

110 Merchants Row
4th Floor, Suite 15
Rutland, VT 05701
Telephone: 802.747.3080
Fax: 802.747.4820

E-mail: info@ottercreek.com

STAMP AND SIGNATURE:

DESIGN ENGINEER

THESE DRAWINGS SHALL NOT BE ALTERED IN ANY WAY WITHOUT THE WRITTEN APPROVAL OF THE ENGINEER. ANY REVISIONS SHALL BE MADE BY THE ENGINEER AND NOTED IN THE REVISION BLOCK. © 2019

OTTER CREEK ENGINEERING, INC.

MAGNETIC NORTH

RUTLAND COUNTY SOLID WASTE DISTRICT

FACILITY IMPROVEMENTS

RUTLAND, VERMONT

PERMITTING

DATE ISSUED: 3/26/2020

REVISIONS:

DRAWN BY: BB - PGF
CHECKED BY: CJ

SCALE: 1"=20'
PROJECT NO.: 475.003
CADD FILE: 475-003

TITLE: **PLANTING PLAN**

DRAWING NO. **C-1**